



Fastener
Solutions

Elastic Staple Marketing Specifications

For the following part numbers:

11625-0	11645-0	11710-0	11720-0	11730-0
11626-0	11646-0	11711-0	11721-0	11731-0
11627-0	11647-0	11712-0	11722-0	11732-0
11628-0	11648-0		11723-0	11733-0
11629-0	11649-0		11724-0	11734-0
11630-0	11650-0		11725-0	11735-0
11631-0	11651-0		11726-0	11736-0
11632-0	11652-0		11727-0	11737-0
11633-0	11653-0		11728-0	11738-0
11634-0	11654-0		11729-0	11739-0
11635-0	11655-0			
11636-0	11656-0			
11637-0	11657-0			
11638-0	11658-0			
11639-0	11659-0			
11640-0	11660-0			
11641-0	11661-0			
11642-0	11662-0			
11643-0	11663-0			
11644-0	11664-0			
11685-0	11690-0			
11686-0	11691-0			
11687-0	11692-0			
11688-0	11693-0			
11689-0	11694-0			

Ecotach Elastic Staples
11750-0 to 11769-0

January 5, 2022

AVERY DENNISON MARKETING SPECIFICATION

TENSILE STRENGTH:	5.0 LBSF. MINIMUM [2.27 KG]
MATERIAL:	POLYURETHANE
WEIGHT:	SEE TABLE
PACKAGE:	10,000 PER REEL
APPLICATION MACHINE(S):	11600,11605 IndES® Module (All staple sizes) 11601,11606 IndES® Module (All staple sizes) 11603 IndES® Hosiery Benchmount (All staple sizes) 10790 VNS (All sizes except 85mm - 200mm) 10797 SNS (All sizes except 85mm - 200mm)

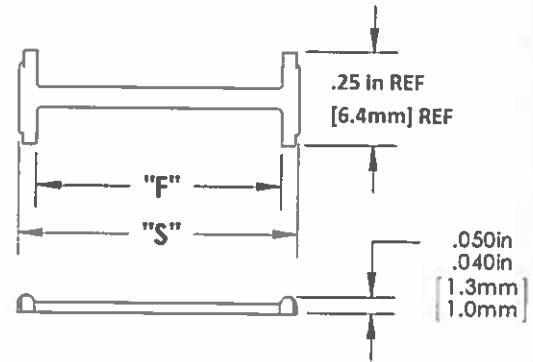

TOLERANCE: +/- .01 [0.25mm]

DRAWING NOT TO SCALE

PART # NATURAL	PART # BLACK	DESCRIPTION		DIM "S"		DIM "F"		DIMENSIONS F&S +/- TOLERANCE		MINIMUM ELONGATION		WEIGHT +/-5%
		MM	INCH	MM	INCH	MM	INCH	MM	INCH	MM	INCH	GRAMS
11625-0	11645-0	15	1/2	14.7	0.58	12.4	0.49	1.5	.06	25.4	1.00	0.025
11626-0	11646-0	19	3/4	19.1	0.75	16.7	0.66	1.5	.06	25.4	1.00	0.026
11627-0	11647-0	25	1	25.4	1.00	23.0	0.91	1.5	.06	44.5	1.75	0.027
11628-0	11648-0	30	1-3/16	30.0	1.18	27.6	1.09	1.5	.06	44.5	1.75	0.030
11629-0	11649-0	33	1-1/4	32.8	1.29	30.4	1.20	1.5	.06	44.5	1.75	0.031
11630-0	11650-0	37	1-1/2	37.3	1.47	35.0	1.38	1.5	.06	44.5	1.75	0.032
11631-0	11651-0	41	1-5/8	41.1	1.62	38.8	1.53	1.5	.06	44.5	1.75	0.032
11632-0	11652-0	44	1-3/4	44.5	1.75	42.1	1.66	1.5	.06	82.5	3.25	0.036
11633-0	11653-0	50	2	50.3	1.98	47.9	1.89	1.5	.06	82.5	3.25	0.041
11634-0	11654-0	54	2-1/8	54.1	2.13	51.7	2.04	1.5	.06	82.5	3.25	0.042
11635-0	11655-0	58	2-1/4	57.9	2.28	55.5	2.19	1.5	.06	82.5	3.25	0.043
11636-0	11656-0	64	2-1/2	63.5	2.50	61.1	2.41	1.5	.06	101.5	4.00	0.051
11637-0	11657-0	68	2-5/8	68.3	2.69	66.0	2.60	1.5	.06	101.5	4.00	0.052
11638-0	11658-0	73	2-7/8	73.2	2.88	70.8	2.79	3.0	.12	101.5	4.00	0.052
11639-0	11659-0	75	2-15/16	74.9	2.95	72.6	2.86	3.0	.12	101.5	4.00	0.053
11640-0	11660-0	80	3-1/8	80.3	3.16	77.9	3.07	3.0	.12	101.5	4.00	0.053
11641-0	11661-0	85	3-3/8	84.8	3.34	82.5	3.25	3.0	.12	190.5	7.50	0.075
11642-0	11662-0	90	3-1/2	90.2	3.55	87.8	3.46	4.0	.16	190.5	7.50	0.075
11643-0	11663-0	95	3-3/4	94.7	3.73	92.4	3.64	4.0	.16	190.5	7.50	0.076
11644-0	11664-0	100	3-15/16	100.1	3.94	97.7	3.85	4.5	.18	190.5	7.50	0.076
11685-0	11690-0	110	4-5/16	110.0	4.33	107.6	4.24	4.5	.18	190.5	7.50	0.076
11686-0	11691-0	120	4-3/4	120.0	4.73	117.6	4.63	4.5	.18	190.5	7.50	0.076
11687-0	11692-0	130	5-1/8	130.0	5.12	127.6	5.03	4.5	.18	190.5	7.50	0.076
11688-0	11693-0	140	5-1/2	140.0	5.52	137.4	5.41	4.5	.18	190.5	7.50	0.077
11689-0	11694-0	150	5-7/8	150.0	5.91	147.1	5.79	4.5	.18	190.5	7.50	0.077
11710-0	N/A	165	6-1/2	165.0	6.50	162.8	6.41	6.0	.24	220.0	8.66	0.083
11711-0	N/A	180	7-3/16	180.0	7.09	177.8	7.00	6.0	.24	220.0	8.66	0.084
11712-0	N/A	200	7-7/8	200.0	7.88	197.8	7.79	6.0	.24	220.0	8.66	0.084

DESCRIPTION:
IndES® (Industrial Elastic Staple) Fastener

Eng Approval
[Signature] 9/11/18

QA Approval
[Signature] 09/11/2018



FASTENER DIVISION
FITCHBURG, MA 01420 USA
TEL: 1-800-225-6913
MA: 1-978-353-8157

STOCK NO. SEE TABLE

REV
F

AVERY DENNISON MARKETING SPECIFICATION

TENSILE STRENGTH:	6.0 LBSF. MINIMUM [2.72 KG]
MATERIAL:	POLYURETHANE
WEIGHT:	0.026min/0.077max GRAMS
PACKAGE:	15,000 PER REEL / 150,000 PER CASE
APPLICATION MACHINE(S):	11601,11606 IndES™ Module (All staple sizes) 11603 IndES™Hosiery Benchmount (All staple sizes)

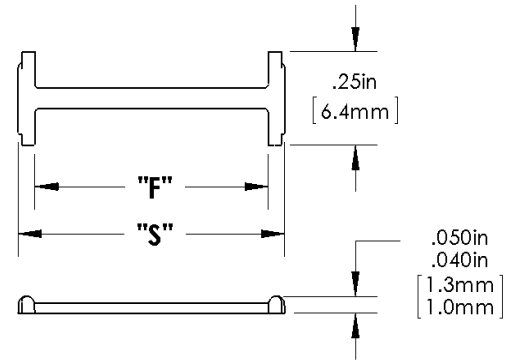

TOLERANCE: +/- .01 [0.25mm]

DRAWING NOT TO SCALE

PART # NATURAL	PART # BLACK	DESCRIPTION		DIM "S"		DIM "F"		DIMENSIONS F&S +/- TOLERANCE		MINIMUM ELONGATION	
		MM	INCH	MM	INCH	MM	INCH	MM	INCH	MM	INCH
11720-1	11730-1	25	1	25	0.99	22.5	.89	1.5	.06	44.5	1.75
11721-1	11731-1	37	1-1/2	37	1.46	34.5	1.36	1.5	.06	44.5	1.75
11722-1	11732-1	45	1-3/4	45	1.77	42.5	1.68	1.5	.06	82.5	3.25
11723-1	11733-1	55	2-3/16	55	2.17	52.5	2.07	1.5	.06	82.5	3.25
11724-1	11734-1	65	2-9/16	65	2.52	62.5	2.46	1.5	.06	101.5	4.00
11725-1	11735-1	75	2-15/16	75	2.96	72.5	2.86	3.0	.12	101.5	4.00
11726-1	11736-1	90	3-1/2	90	3.55	87.5	3.45	4.0	.16	190.5	7.50
11727-1	11737-1	100	3-15/16	100	3.94	97.5	3.85	4.5	.18	190.5	7.50

**DESCRIPTION: IndES® (Industrial Elastic Staple)
Heavy Duty Fastener**

Eng Approval
Bill Cooper 2/18/21

QA Approval
Rick Estano 2/18/21



FASTENER DIVISION TEL: 1-800-225-5913
FITCHBURG, MA 01420 USA MA: 1-978-353-8157

STOCK NO.

SEE TABLE

REV
D

AVERY DENNISON MARKETING SPECIFICATION

TENSILE STRENGTH:	5.0 LBSF. MINIMUM [2.27 KG]
MATERIAL:	Proprietary POLYURETHANE Blend
WEIGHT:	SEE TABLE
PACKAGE:	15,000 PER REEL / 150,000 PER CASE
APPLICATION MACHINE(S):	11600,11605 IndES™ Module (All staple sizes) 11601,11606 IndES™ Module (All staple sizes) 11603 IndES™ Hosiery Benchmount (All staple sizes) 10790 VNS (All sizes except 85mm - 100mm) 10797 SNS (All sizes except 85mm - 100mm)

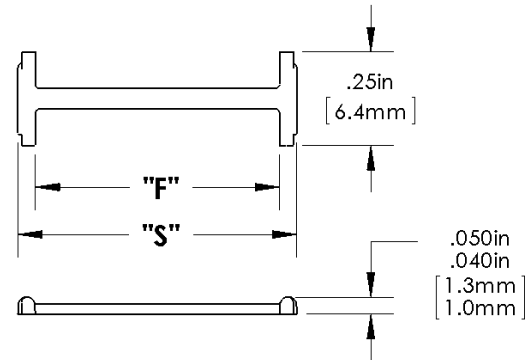

TOLERANCE: +/- .01 [0.25mm]

DRAWING NOT TO SCALE

PART #	COLOR	DESCRIPTION		DIM "S"		DIM "F"		DIMENSIONS F&S +/- TOLERANCE		MINIMUM ELONGATION		WEIGHT +/-5%
		MM	INCH	MM	INCH	MM	INCH	MM	INCH	MM	INCH	GRAMS
11750-0	NATURAL	15	1/2	14.7	0.58	12.4	0.49	1.5	.06	25.4	1.00	.025
11751-0	NATURAL	19	3/4	19.1	0.75	16.7	0.66	1.5	.06	25.4	1.00	.026
11752-0	NATURAL	25	1	25.4	1.00	23.0	0.91	1.5	.06	44.5	1.75	.027
11753-0	NATURAL	30	1-3/16	30.0	1.18	27.6	1.09	1.5	.06	44.5	1.75	.030
11754-0	NATURAL	33	1-1/4	32.8	1.29	30.4	1.20	1.5	.06	44.5	1.75	.031
11755-0	NATURAL	37	1-1/2	37.3	1.47	35.0	1.38	1.5	.06	44.5	1.75	.032
11756-0	NATURAL	41	1-5/8	41.1	1.62	38.8	1.53	1.5	.06	44.5	1.75	.032
11757-0	NATURAL	44	1-3/4	44.5	1.75	42.1	1.66	1.5	.06	82.5	3.25	.036
11758-0	NATURAL	50	2	50.3	1.98	47.9	1.89	1.5	.06	82.5	3.25	.041
11759-0	NATURAL	54	2-1/8	54.1	2.13	51.7	2.04	1.5	.06	82.5	3.25	.042
11760-0	NATURAL	58	2-1/4	57.9	2.28	55.5	2.19	1.5	.06	82.5	3.25	.043
11761-0	NATURAL	64	2-1/2	63.5	2.50	61.1	2.41	1.5	.06	101.5	4.00	.051
11762-0	NATURAL	68	2-5/8	68.3	2.69	66.0	2.60	1.5	.06	101.5	4.00	.052
11763-0	NATURAL	73	2-7/8	73.2	2.88	70.8	2.79	3.0	.12	101.5	4.00	.052
11764-0	NATURAL	75	2-15/16	74.9	2.95	72.6	2.86	3.0	.12	101.5	4.00	.053
11765-0	NATURAL	80	3-1/8	80.3	3.16	77.9	3.07	3.0	.12	101.5	4.00	.053
11766-0	NATURAL	85	3-3/8	84.8	3.34	82.5	3.25	3.0	.12	190.5	7.50	.075
11767-0	NATURAL	90	3-1/2	90.2	3.55	87.8	3.46	4.0	.16	190.5	7.50	.075
11768-0	NATURAL	95	3-3/4	94.7	3.73	92.4	3.64	4.0	.16	190.5	7.50	.076
11769-0	NATURAL	100	3-15/16	100.1	3.94	97.7	3.85	4.5	.18	190.5	7.50	.076

DESCRIPTION: IndES® Ecotach™ Elastic Staple® Fastener		ENG. APPROVAL: <i>Bill Cooper 11/19/21</i>	QA. APPROVAL: <i>Rich Estano 11/19/21</i>
 AVERY DENNISON	FASTENER DIVISION FITCHBURG, MA 01420 USA 1-800-225-5913 / 1-978-353-8157 fastener.averydennison.com		STOCK NO: SEE TABLE
			REV A